



Assembly manual

for joined/ connected units

Connection on long side



SOGECO S.A.
L I V I N G

1

2

3

4

5

6

7

8

A

A

Tools needed

For connecting/ joining the units



Spanner keys

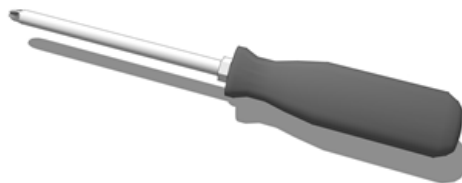

***Screw driver for
cross head screws***



Drill bit



Crowbar

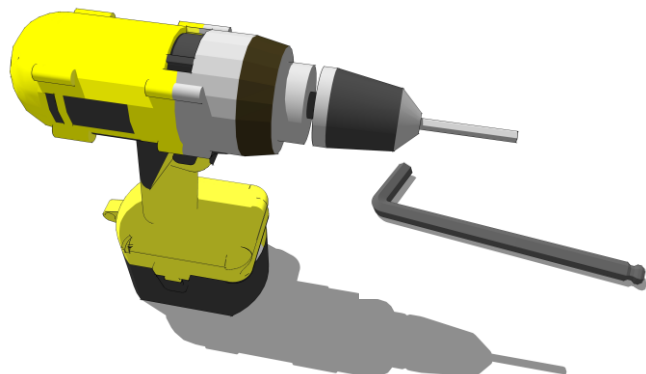

***High speed drill
with 14mm allen
key***

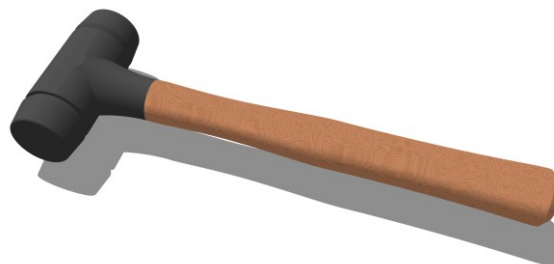

Rubber Hammer



Rubber gloves



1

2

3

4

5

6

7

F

F

1

2

3

4

5

6

7

8

A

A

External***Connection kit set***

B

B

C

C

D

D

E

E

F

F

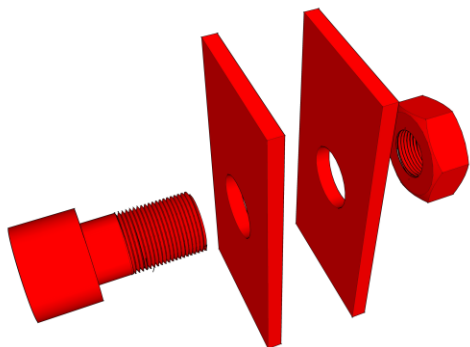

***Horizontal
Connection plate***

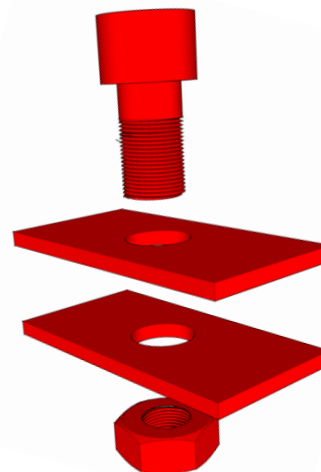

***Vertical
Connection plate***

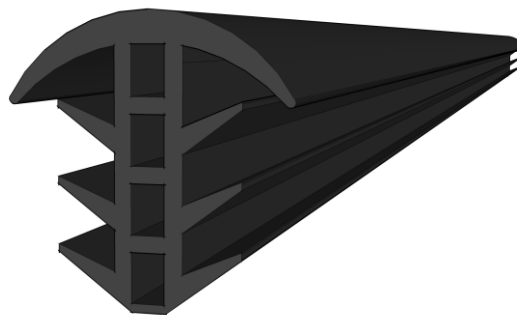

Gasket/ sealing rubber



1

2

3

4

5

6

7

1

2

3

4

5

6

7

8

A

A

Internal***Connection kit set***

B

B

C

C

D

D

E

E

F

F

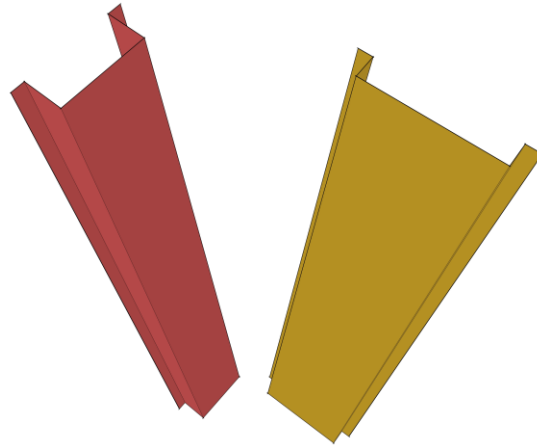

***Vertical flashings to
cover corner posts
connections/ joints***

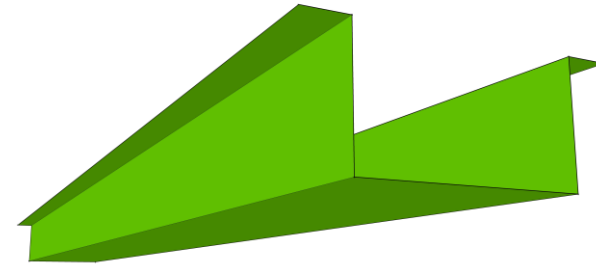

***Ceiling flashing to
cover Roof frame
connections/ joints***



***Plywood strip
floor filler***

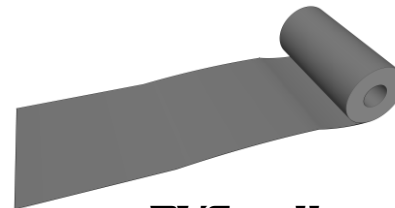

***PVC roll
floor strip***

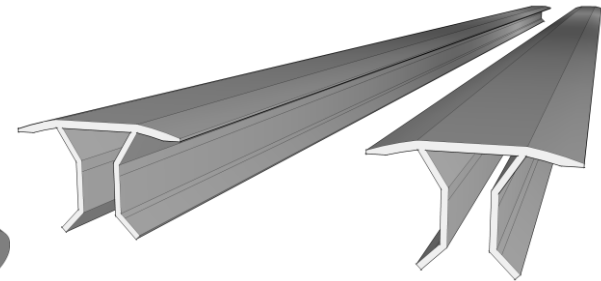

***Aluminum floor
connector trim***



1

2

3

4

5

6

7

1

2

3

4

5

6

7

8

A

A

Connection on *long side*

External side

Position the flatpack containers in location. You can use a crowbar to adjust the alignment of the containers

B

B

C

C

D

D

E

E

F

F

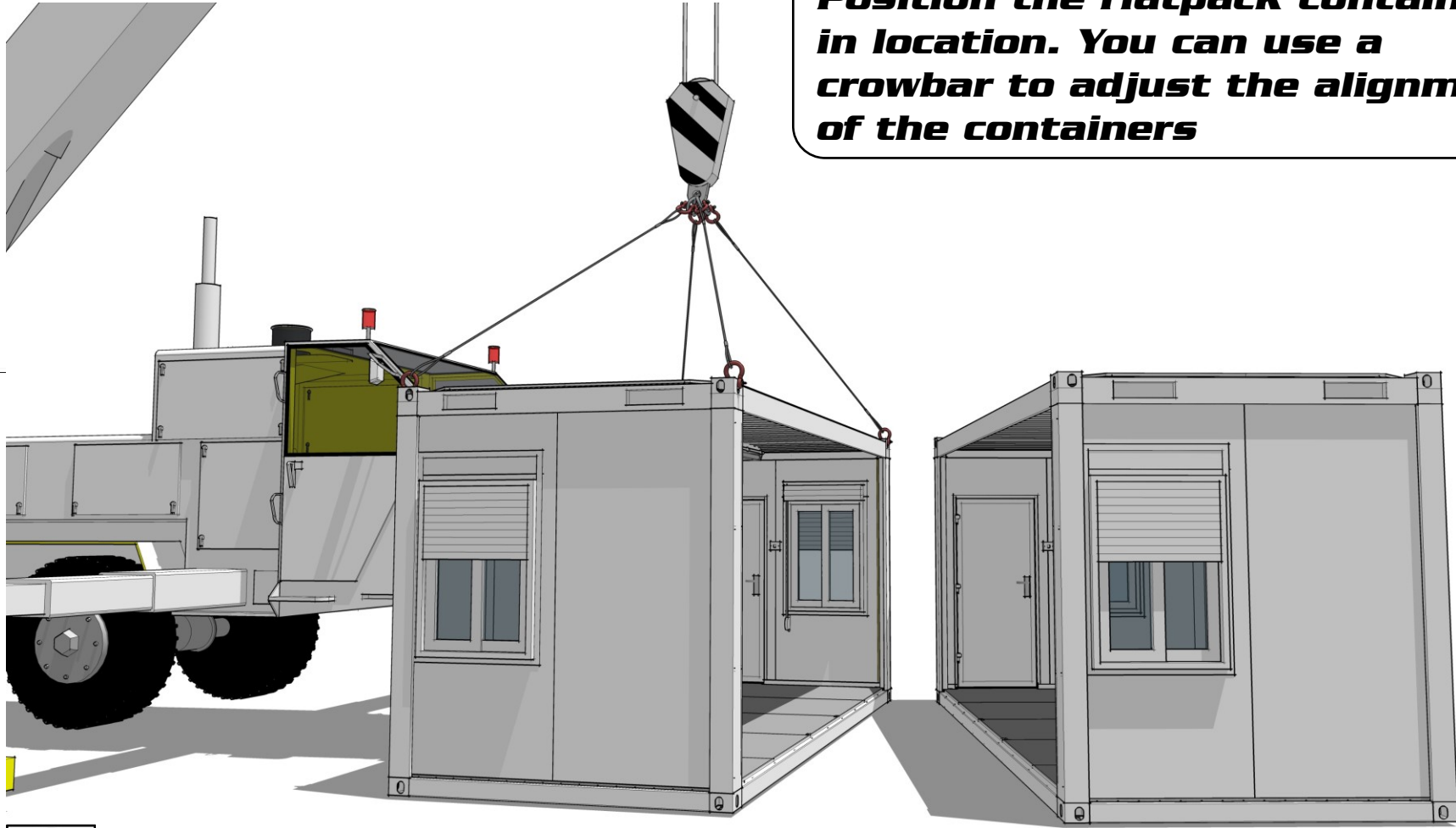

1

2

3

4

5

6

7

1

2

3

4

5

6

7

8

A

B

C

D

E

F

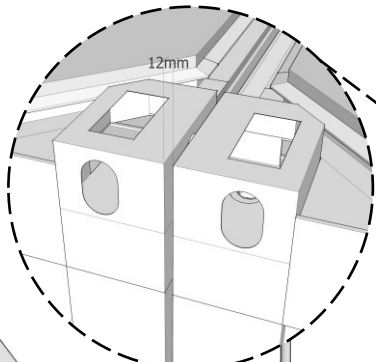

Maintain a 12mm gap between flatpack containers

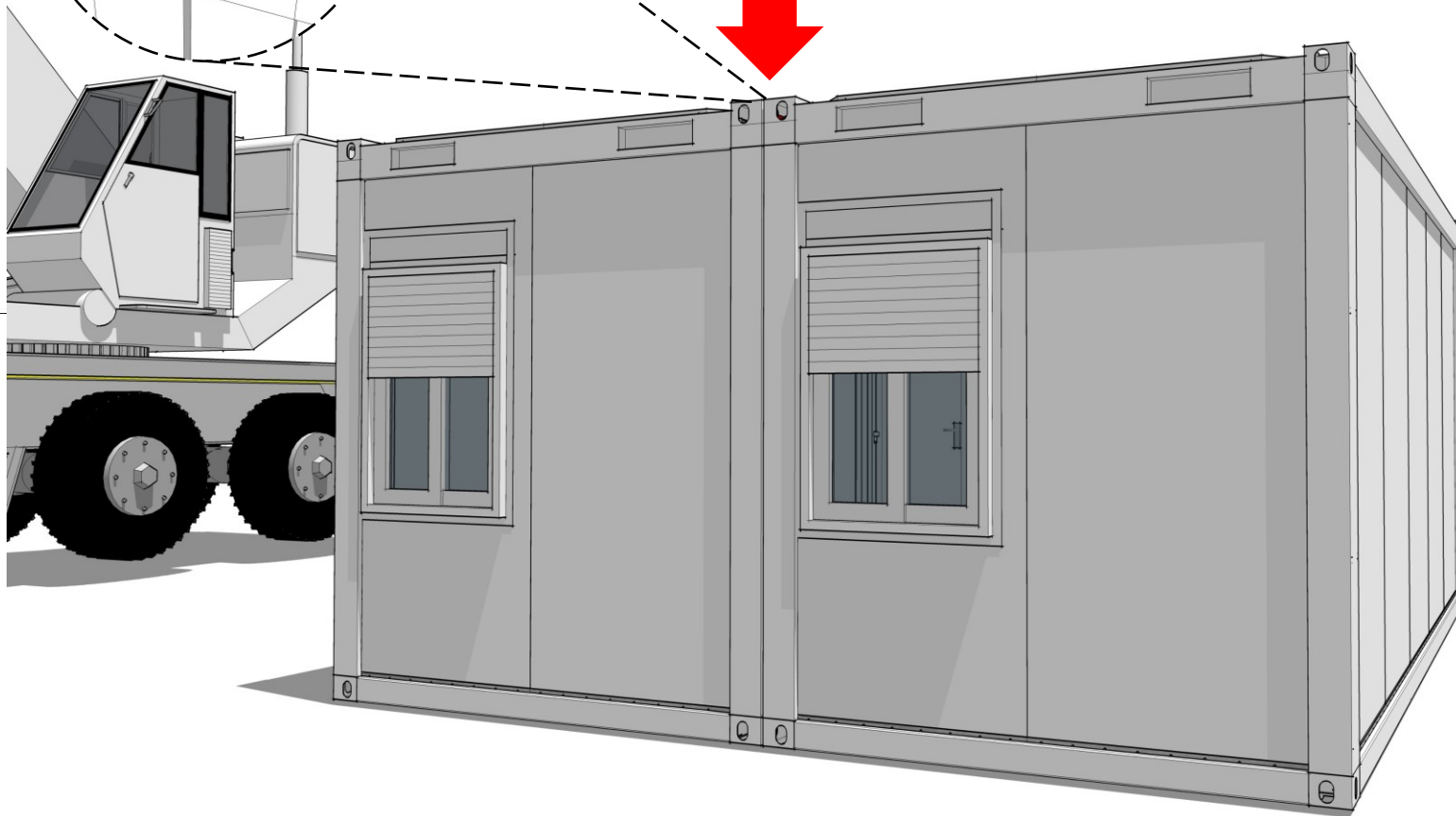

1

2

3

4

5

6

7

1

2

3

4

5

6

7

8

A

B

C

D

E

F

A

B

C

D

E

F

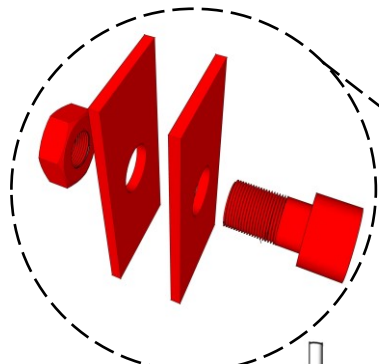

Fix the connection plates on 4 corners. Do not make it tight at this stage.

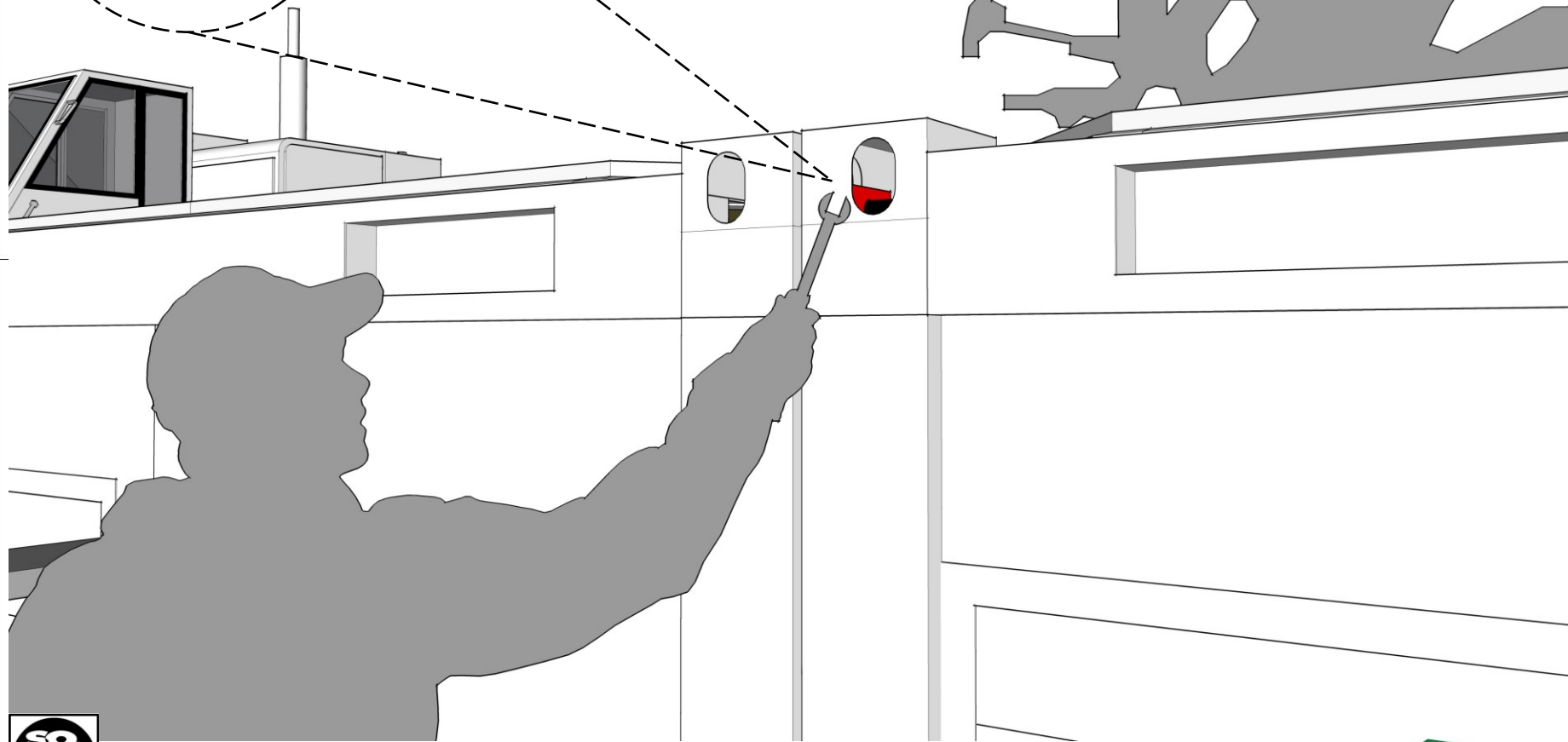

1

2

3

4

5

6

7

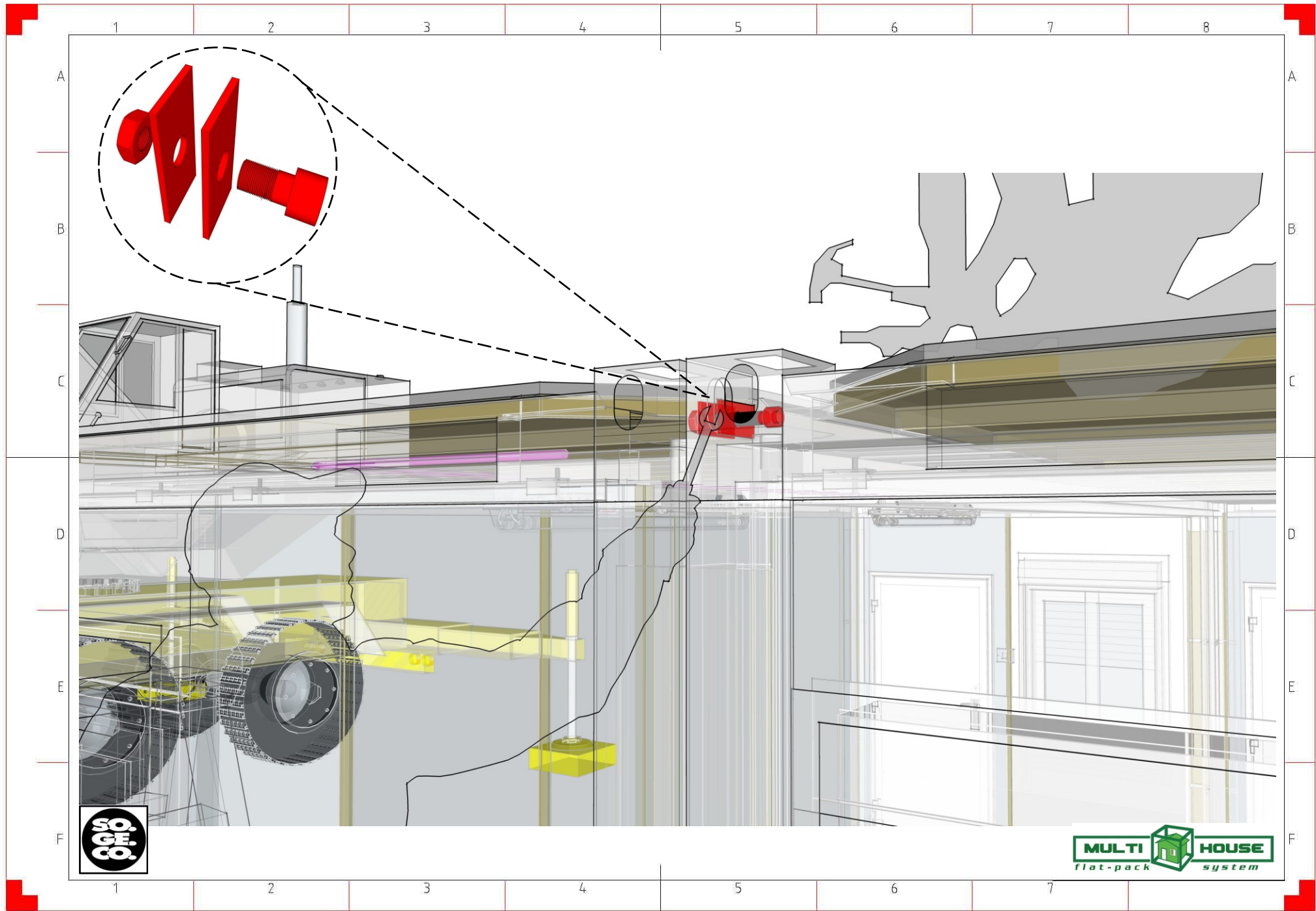

2 sets at top corners and 2 sets at bottom corners. Do not make it tight.

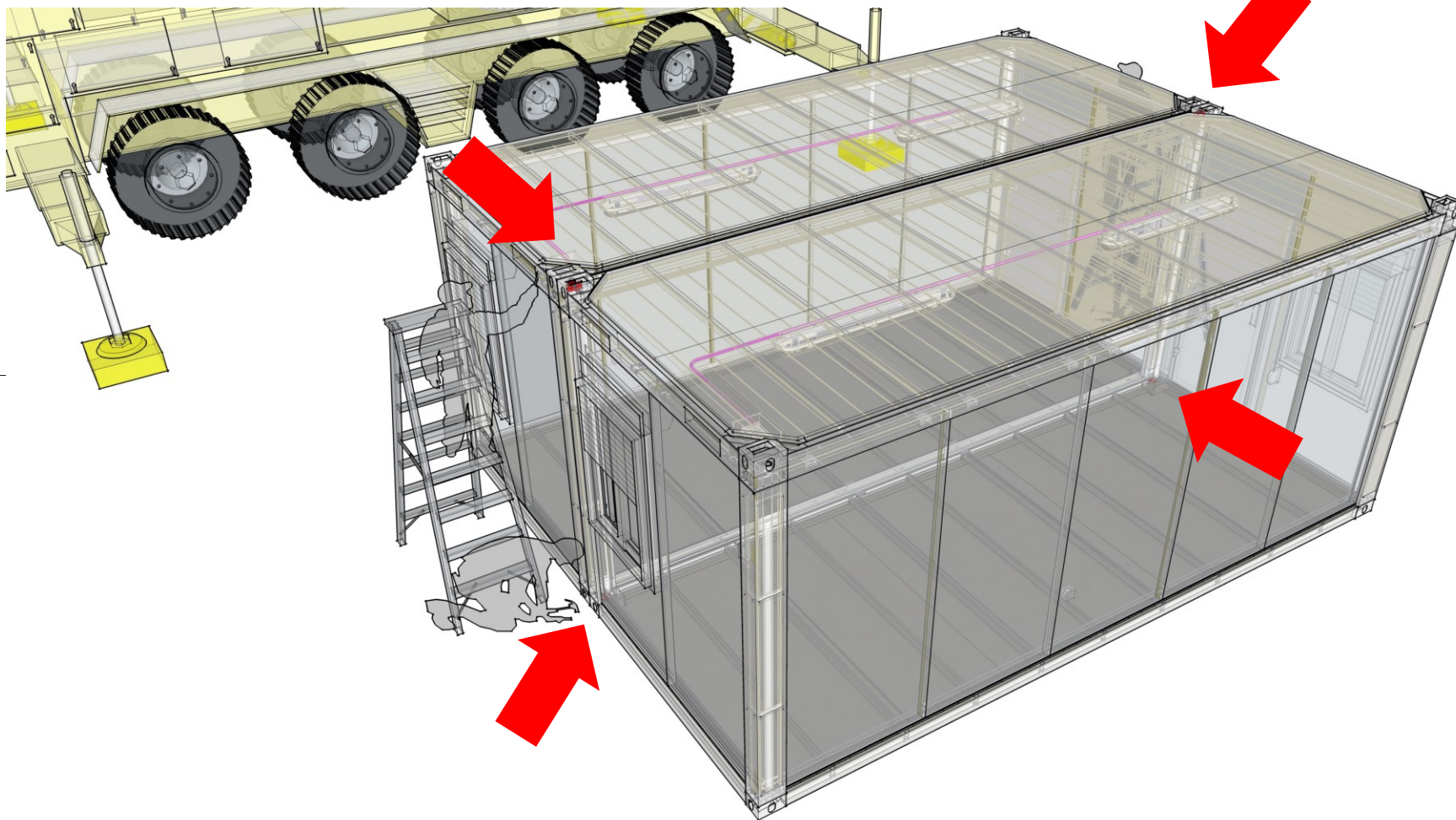

Note:

**To avoid water leakage,
use 1 pc 12m long
sealing rubber all
throughout the long side**

**Install the sealing rubber all
throughout the long side
connection. Use rubber hammer
to push the rubber in place.**

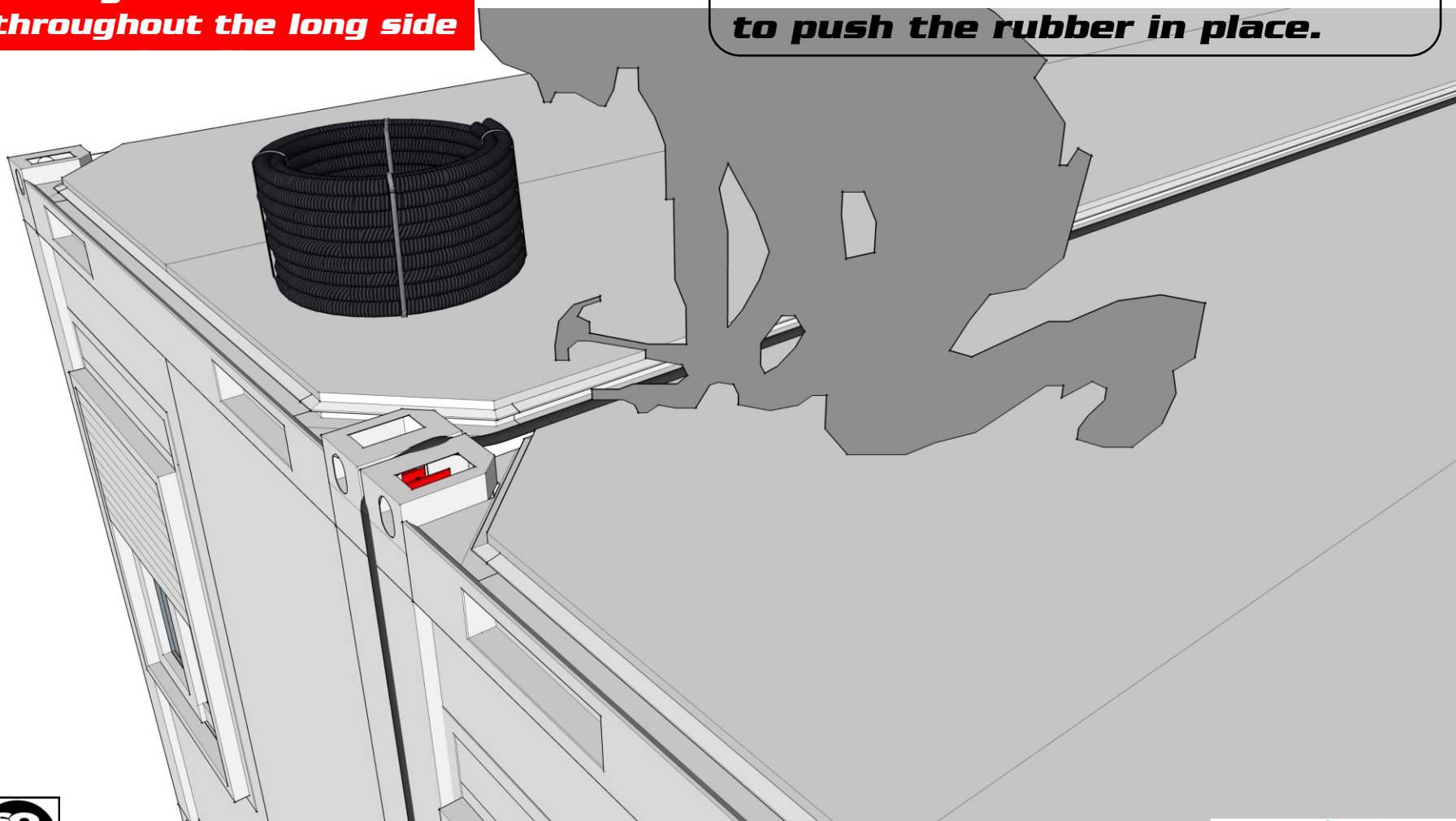

Note:
Make sure sealing
rubber goes around the
top corner as shown

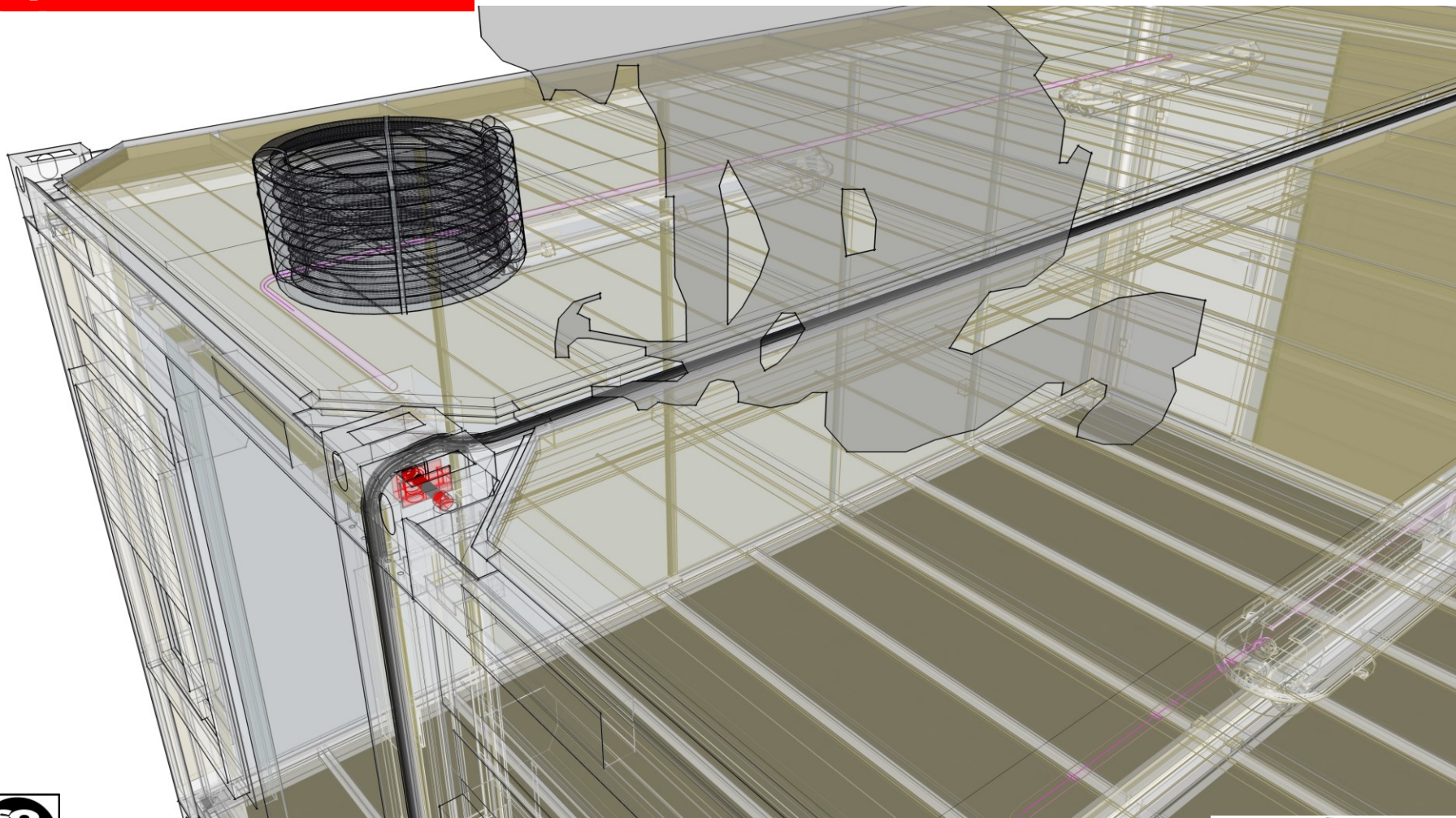

After sealing rubber is installed. Tighten all connection plates. Ensure to maintain consistent gap during tightening all throughout to avoid twisting of frames.

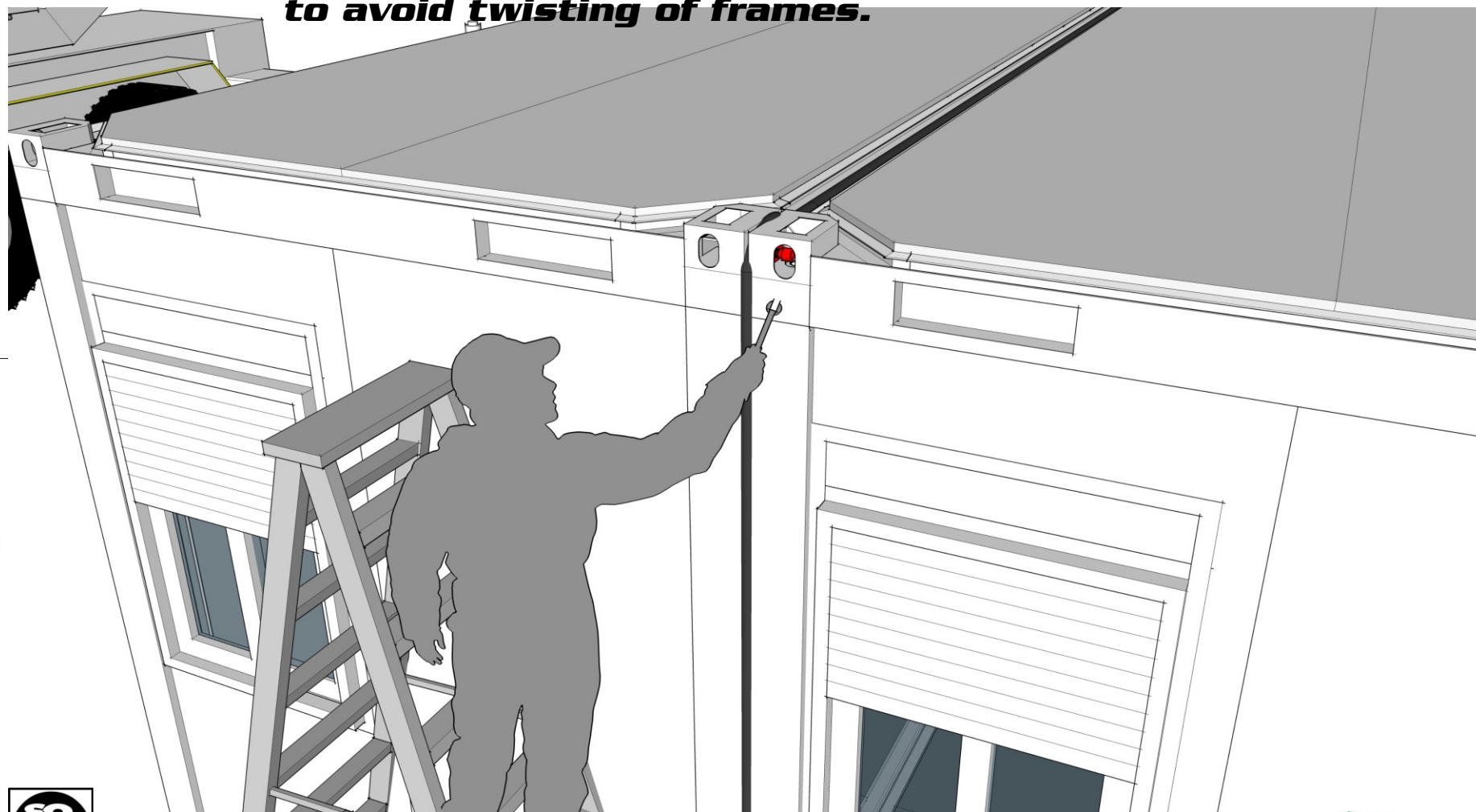

1

2

3

4

5

6

7

8

A

A

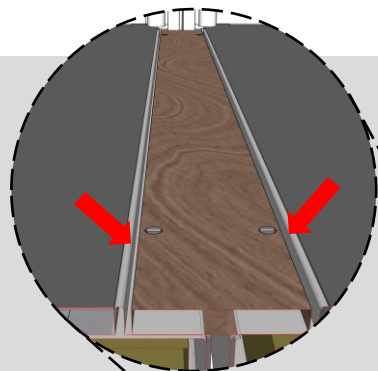
Connection on *long side****Internal side***

Install the plywood strip floor filler by screwing to floor frame. Center the plywood along the floor gap. There should be a sufficient gap between the plywood and the bump of the floor frame to install the aluminum floor connector trim.

B

B

C

C

D

D

E

E

F

F



1

2

3

4

5

6

7

***There are 3 x pcs of Plywood
strip
floor filler on long side***

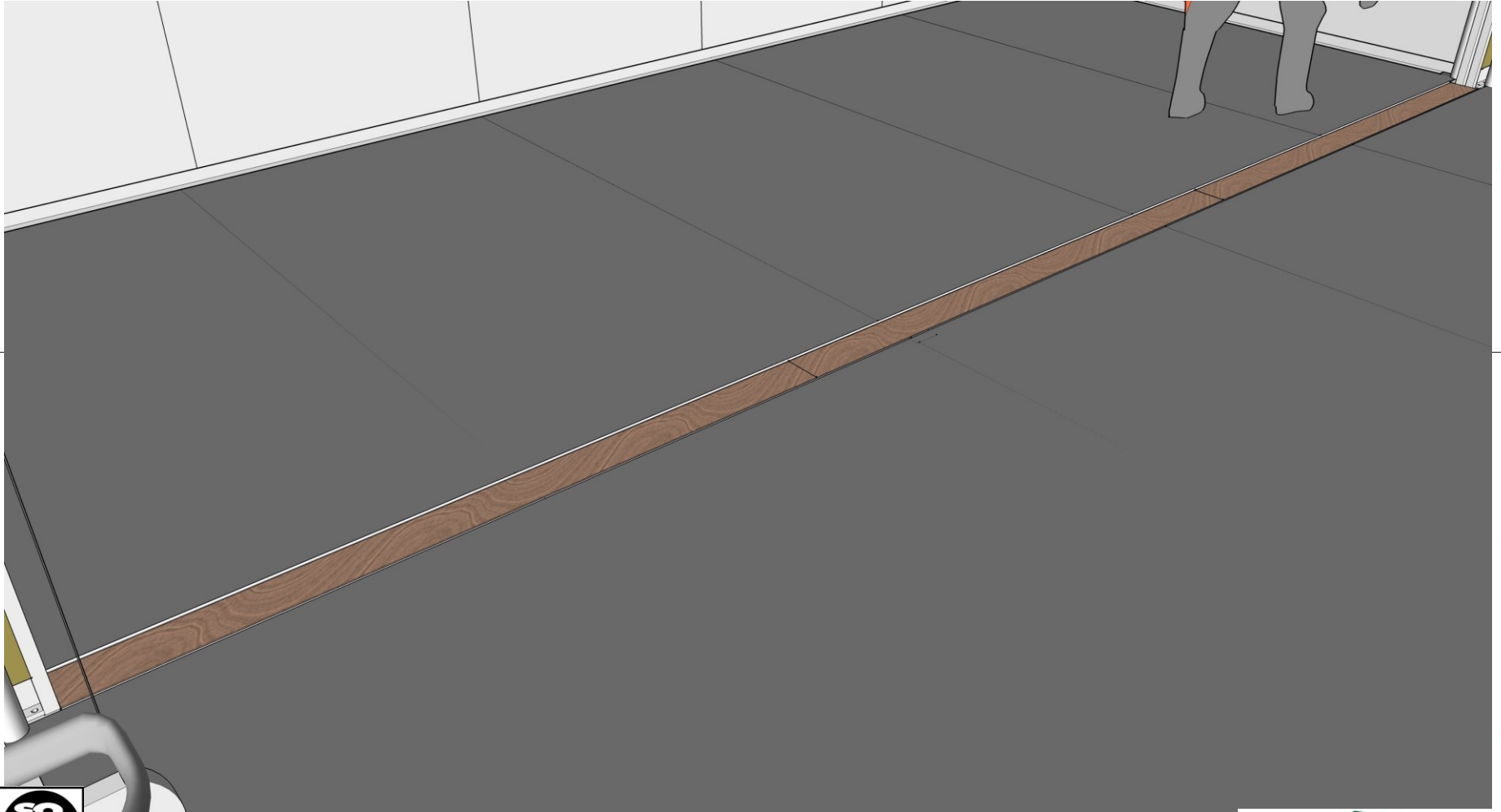

***Fix the PVC roll floor strip on
the plywood strip by glue.***



Make sure to use 1 continuous piece of PVC roll floor strip.

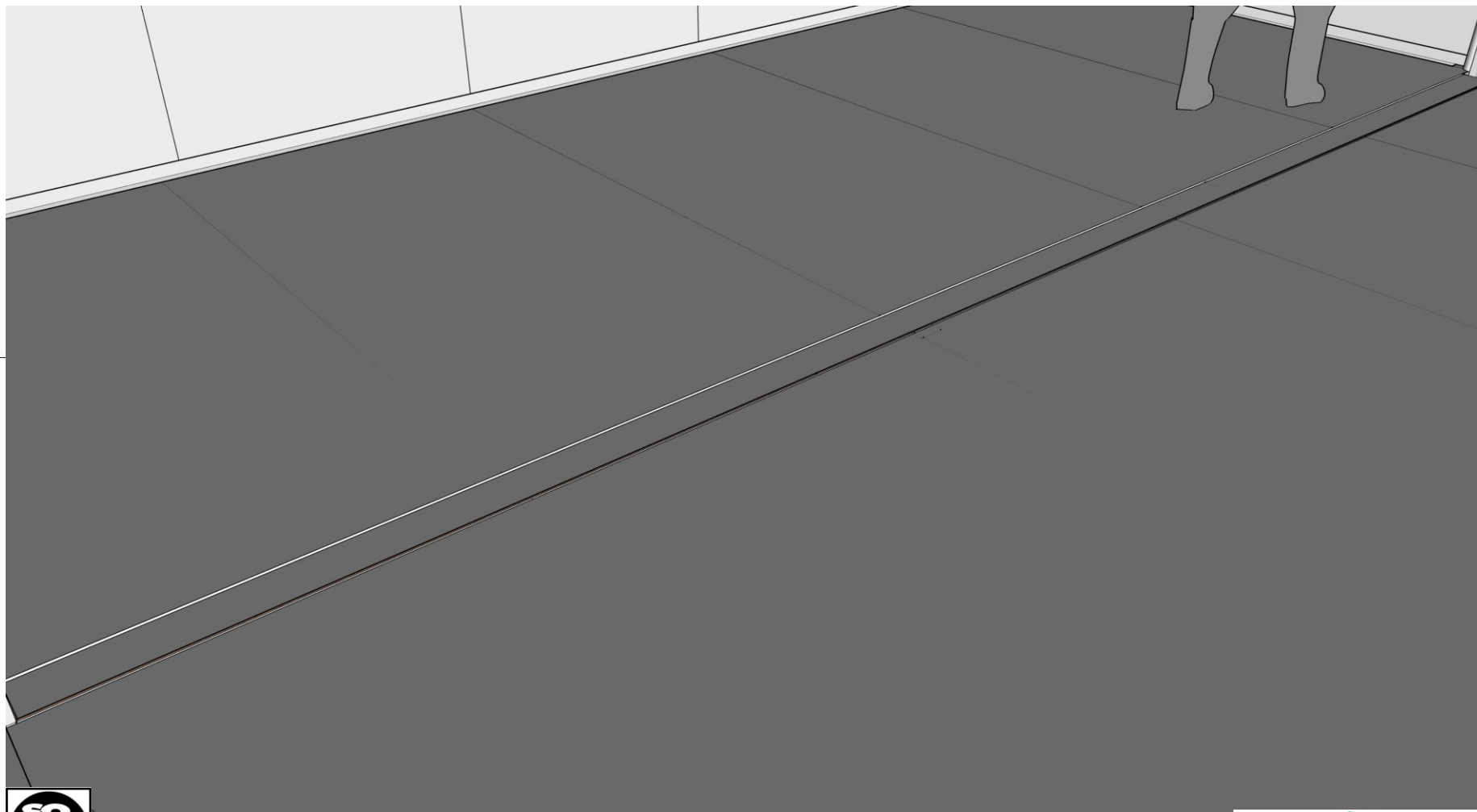

***Install the Vertical flashing
(cover inner post). Cut the top
part to fit. Cutting can be done
in the factory.***

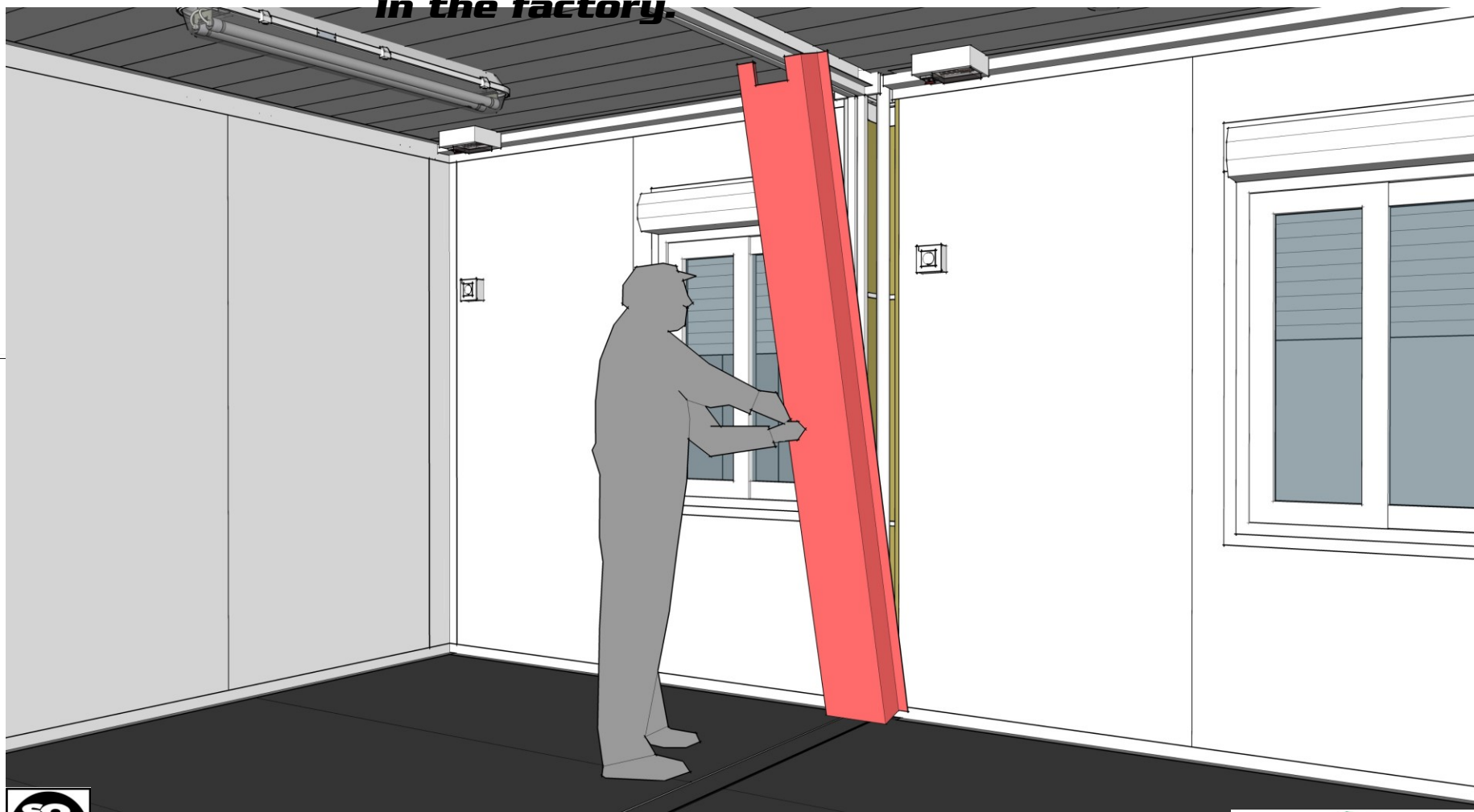

Install the Vertical flashing (to cover inner post). Cut the top part to fit. Also cutting can be done in the factory.

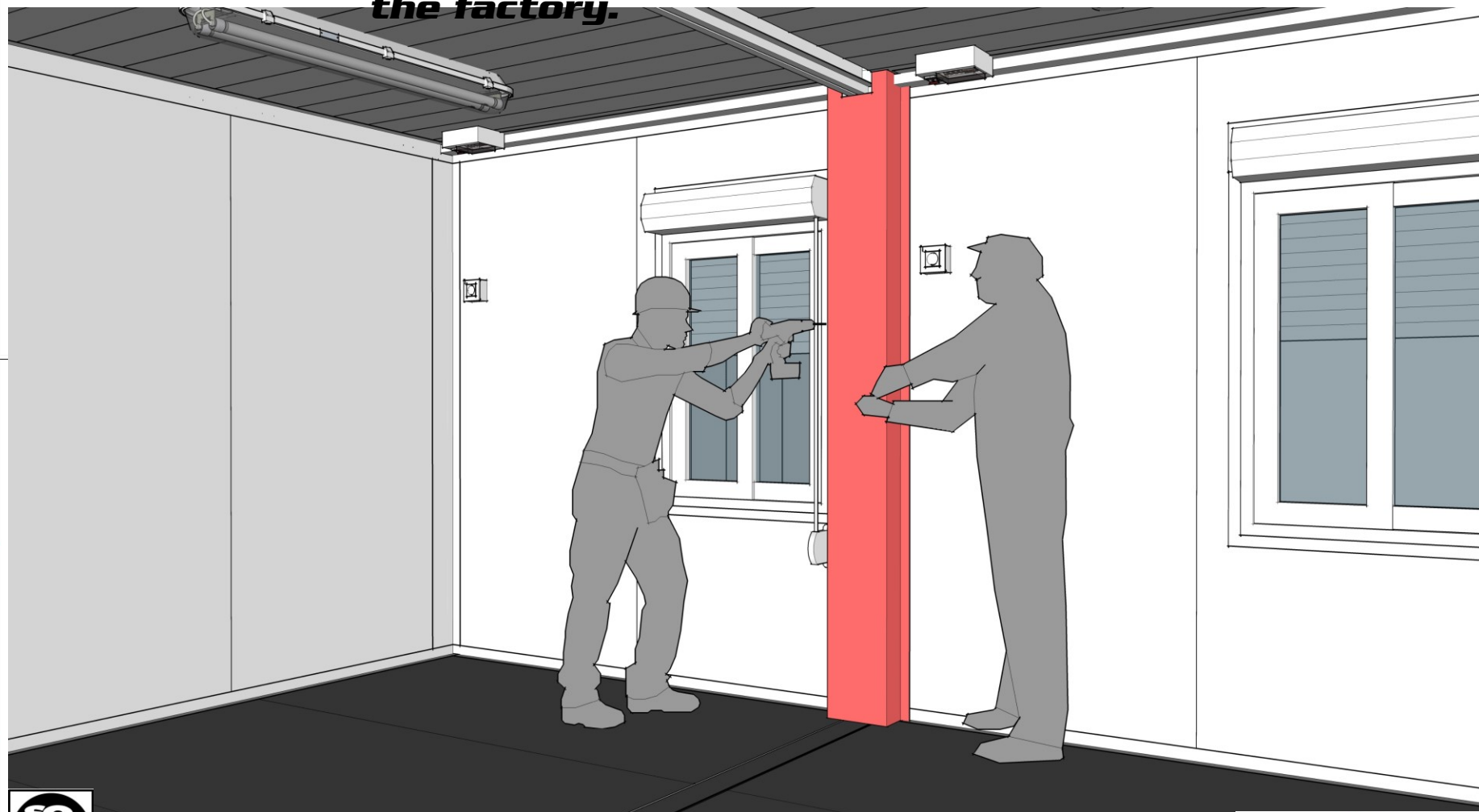

***Install the all vertical flashing in
1 time.***

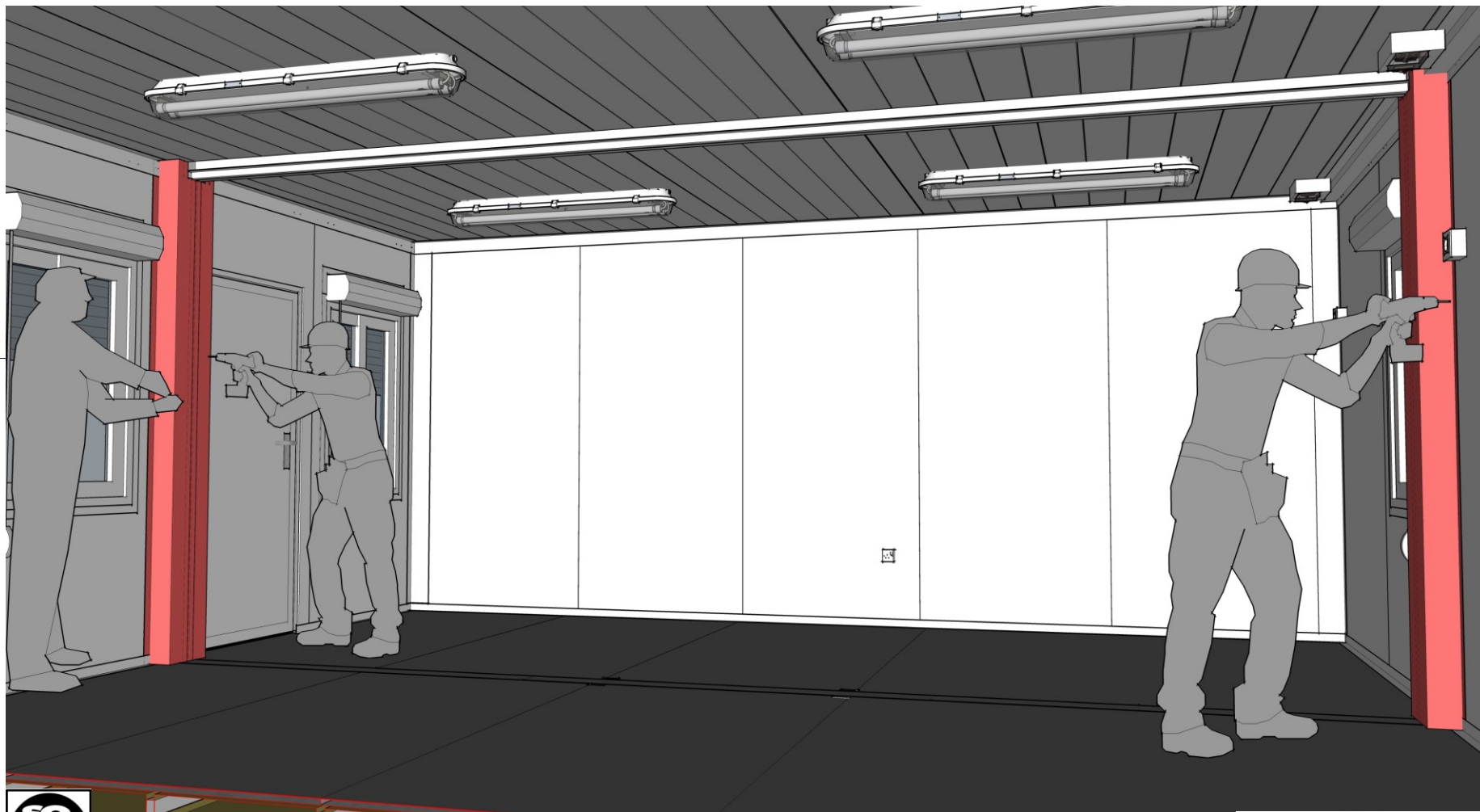

Next, install ceiling flashing. Make sure to get the center before fixing it by screw. Always start on 1 end.

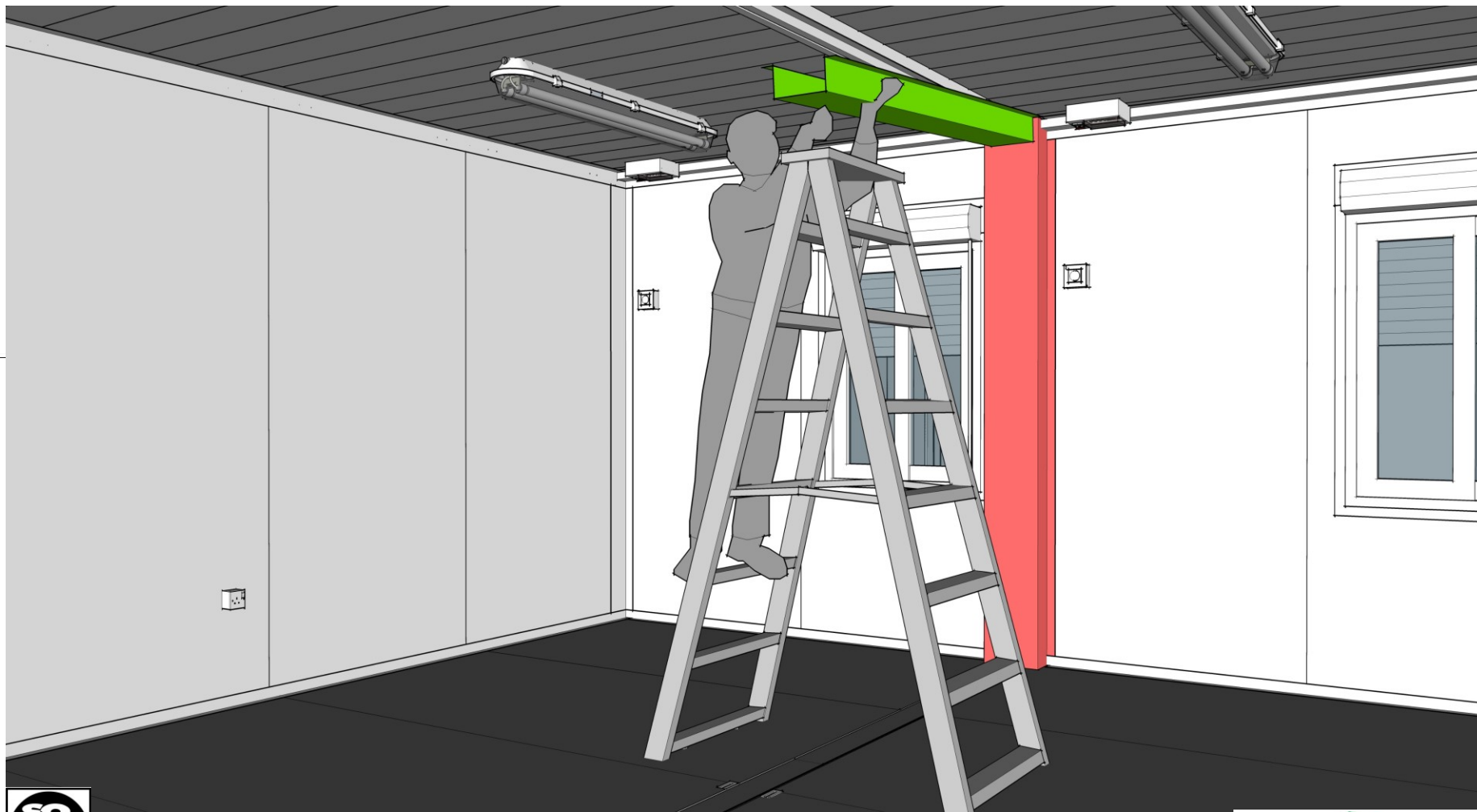

***There are 3 pcs of ceiling
flashing in long side***

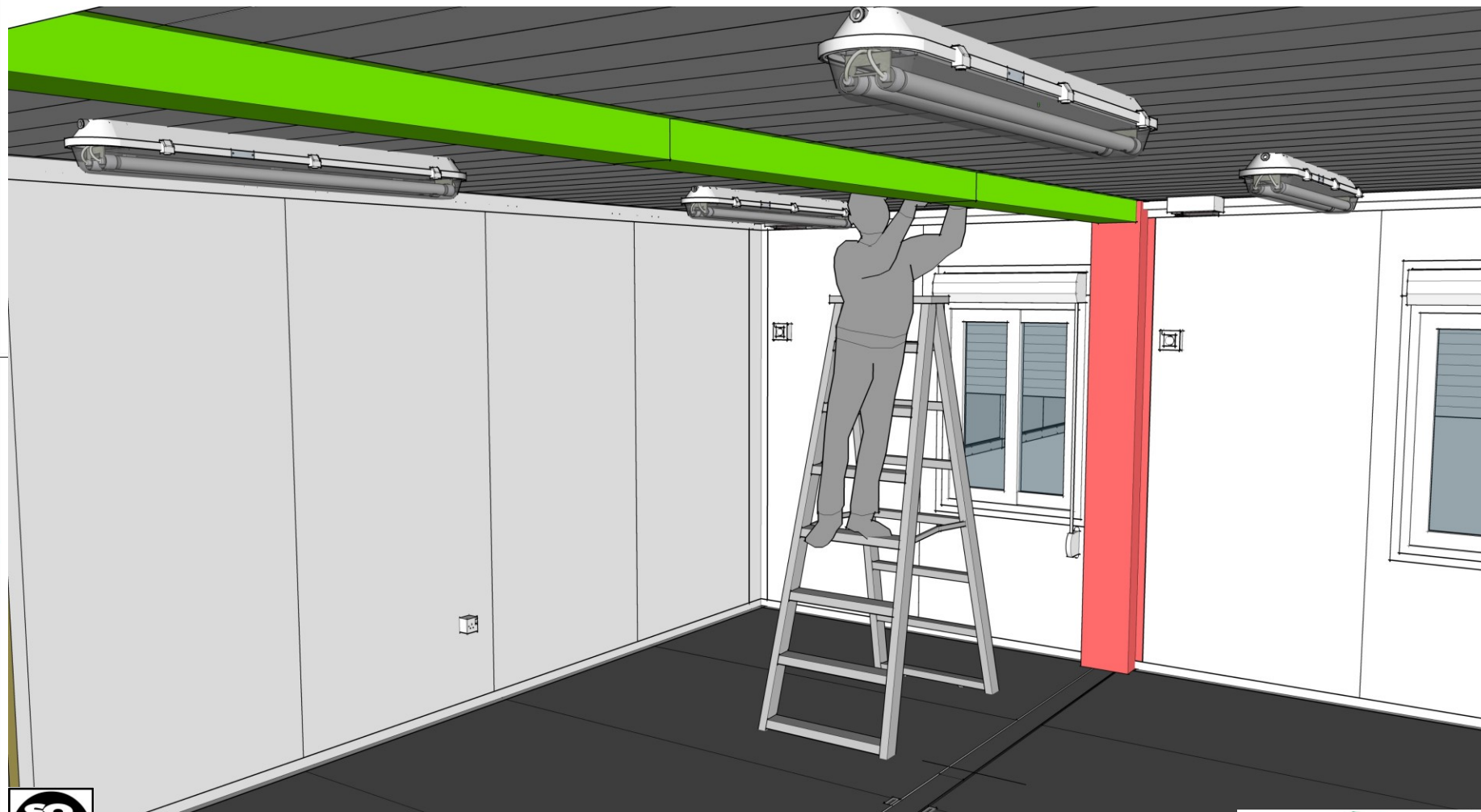

***Install the aluminum floor
connector trim. These are fix
without screws. They are snap
on***

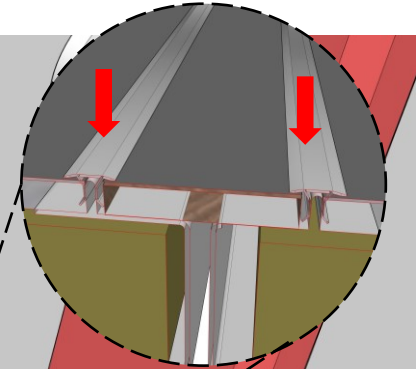

***Push trim to the
groove by using rubber
hammer***



1

2

3

4

5

6

7

8

A

A

Connection on long side**External side**

B

B

**Sealing
rubber/
gasket**

C

C

D

D

**Connectio
n plate
set**

E

E

F

F



1

2

3

4

5

6

7

8

A

A

Connection on long side***Internal side***

B

B

C

C

D

D

E

E

F

F

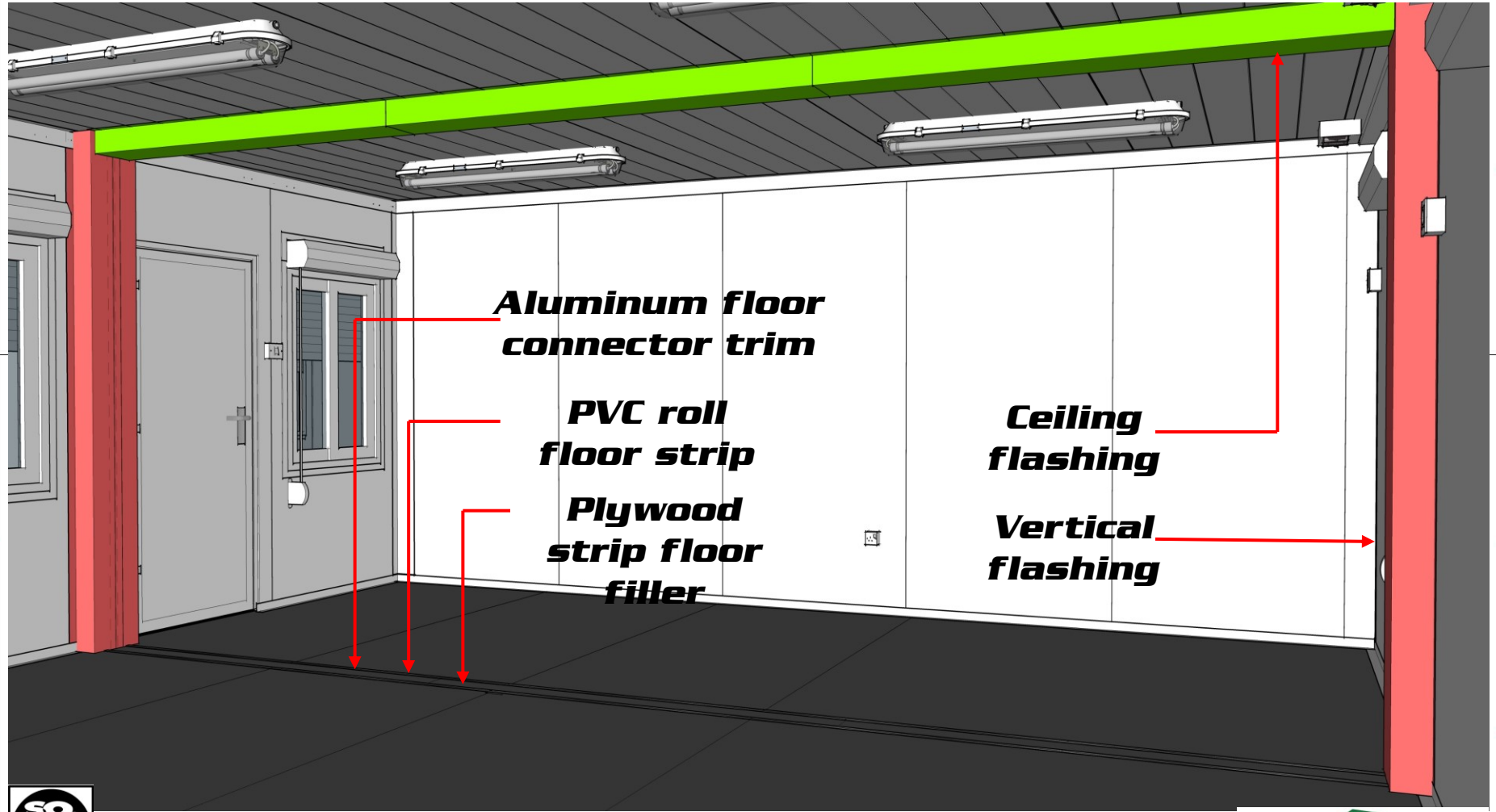

1

2

3

4

5

6

7

Lastly, install a rubber trim on all exposed **TOP** corner holes ONLY. This is to avoid overflowing on water on top corners in case of rain that will leave water stains on corner post paint.

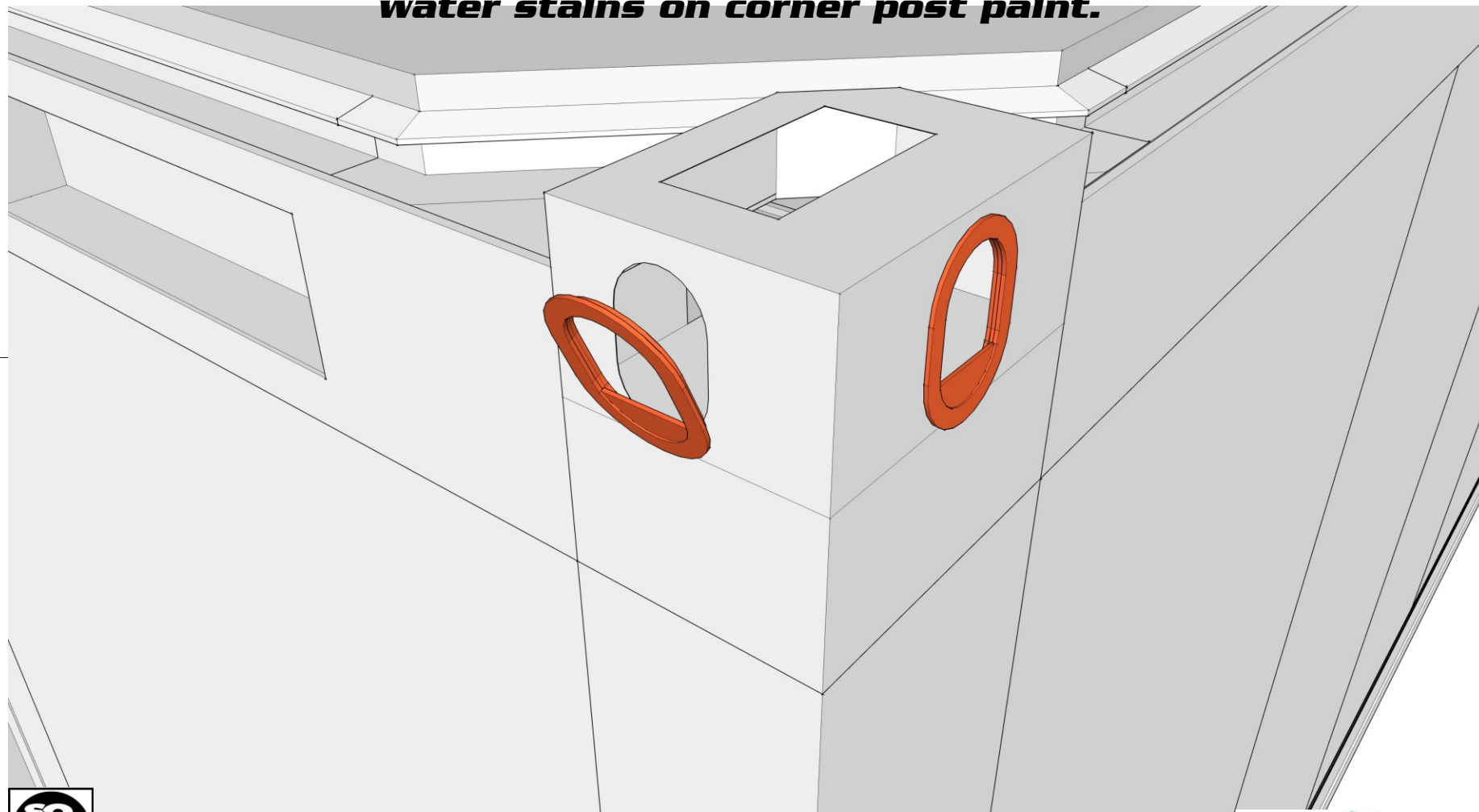

1

2

3

4

5

6

7

8

A

B

C

D

E

F

A

B

C

D

E

F

